

CoolBlock® LX-01-2x6 Rectangle Pin Fin LED Cooler

Accessories

Lens

LEDiL®

Ledil was from day one the driver behind the 2x6 platform. In the mean time they offer a wide range of lenses, both in PMMA as in Silicone, for higher temperatures, all compatible with the 2x6 values.

You can find as well assymetric beam angles for street or outdoor high mast applications, as well as symmetric angles for high bay lighting.

[Click here to get more info about Ledil 2x6 family.](#)

Mounting indicator marks overview

With 8 screws evenly spread over the border area, the 2x6 mechanics in combination with a gasket leads to an IP67 waterproof sealing between optics and LED cooler.

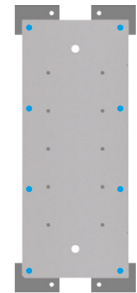

Ledil Strada-IP-2x6 lenses

Model names

- CS14055_STRADA-IP-2X6-T2
- CS14143_STRADA-IP-2X6-T3
- CS14144_STRADA-IP-2X6-ME
- CS15020_STRADA-IP-2X6-VSM

Mounting

- Direct mounting with 8 screws M3 x 8mm
- Blue indicator marks



Ledil HB-IP-2x6 lenses

Model names

- CS14130_HB-IP-2X6-W
- CS14263_HB-IP-2X6-WWW
- CS14597_HB-IP-2X6-O
- CS14891_HB-IP-2X6-M
- CS14895_HB-IP-2X6-RS

Mounting

- Direct mounting with 8 screws M3 x 8mm
- Blue indicator marks

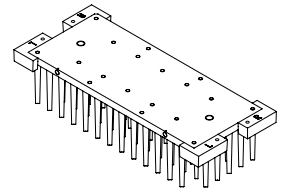
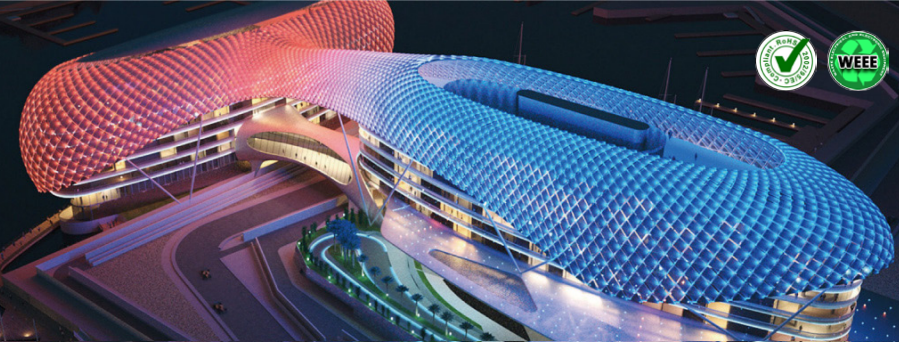

W80 - L192 - H45 (mm)
Rth 1.09 °C/W - Power Pd 45.8W

[MORE PRODUCT DETAILS](#)

CoolBlock® LX-01-2x6 Rectangle Pin Fin LED Cooler

Accessories

Lens

KHATOD®
Optical Solutions for LED Lighting

Khatod, leader manufacturer of Optical Solutions for the major LEDs.

Unique on the international scene, Khatod specifies and develops the entire product process 100% in house, Milano, Italy. All the operations are held on site: design, development of new technologies, production and post-production processes, testing and control, technical direction, management, administration.

Mounting indicator marks overview

With 8 screws evenly spread over the border area, the 2x6 mechanics in combination with a gasket leads to an IP67 waterproof sealing between optics and LED cooler.

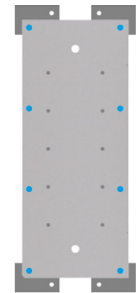

NACTUS 6x2 lenses

Model names

- PLL120001
- PLL120002
- PLL120003
- PLL120004
- PLL120005
- PLL120403
- PLL120404
- PLL120406
- PLL120424
- PLL120425
- PLL120426

Mounting

- Direct mounting with 8 screws M3 x 8mm
- Blue indicator marks

Cable gland

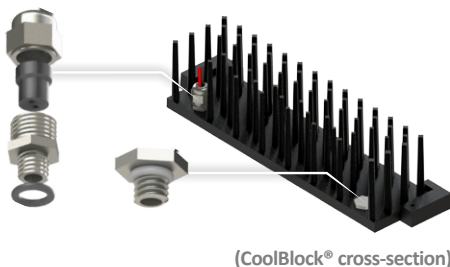

(CoolBlock® cross-section)

Cable feed-through

The 2x6 LED board can be waterproof with the use of an IP67 lens, leaving the cable feed-through the only part that still needs to be take care of. MTX has developed an IP67 2-pole cable gland suitable for cables with a diameter of approximately 1.75mm and a IP67 stopper to close unused cable holes.

Model names

- CoolConnect® Gland 2-pole 01
 - CoolConnect® Stopper Gland
- (In-house potting service available)

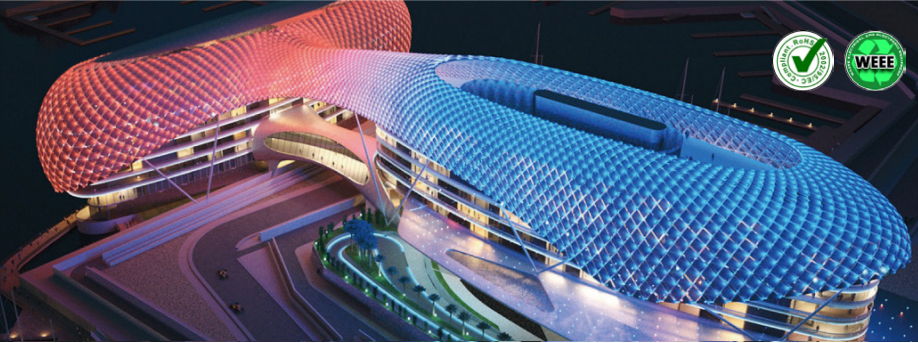

CoolBlock® LX-01 2x6

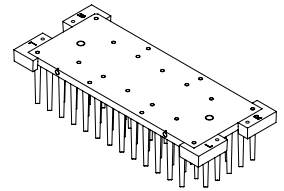

W80 - L192 - H45 (mm)
Rth 1.09 °C/W - Power Pd 45.8W

[MORE PRODUCT DETAILS](#)

CoolBlock® LX-01-2x6 Rectangle Pin Fin LED Cooler

Accessories

Chassis



Chassis mount options

CoolBlock® LX-01-2x6 is foreseen with 4x M3 mounting patterns on four corners to make front mounting with chassis possible.

CoolConnect® M3 button head screws in SUS304 stainless steel with black zinc plating are available from stock in various lengths.

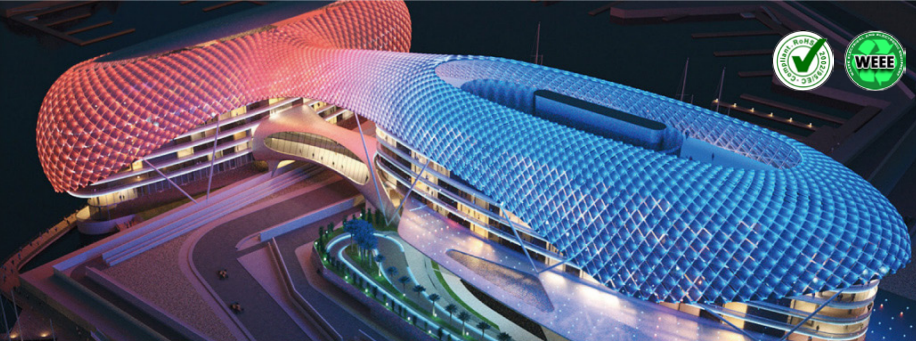

CoolBlock® LX-01 2x6

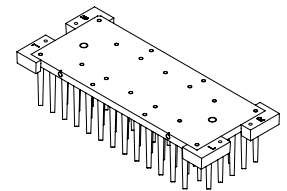

W80 - L192 - H45 (mm)
Rth 1.09 °C/W - Power Pd 45.8W

[MORE PRODUCT DETAILS](#)

CoolBlock® LX-01-2x6 Rectangle Pin Fin LED Cooler

Accessories

Modular / Multi-Heat Sink

1. Place heat sinks in this way that "L" is next to "R".

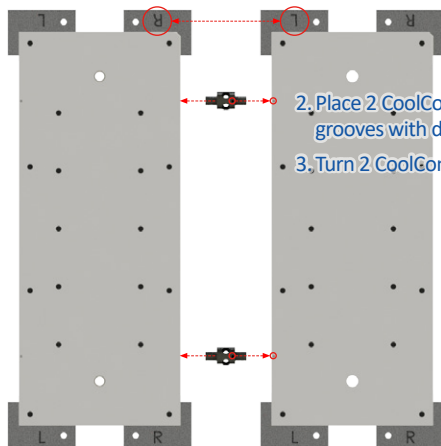

2. Place 2 CoolConnect® Inter-01 in the middle of 2 CoolBlock® LX while align its grooves with dots on heat sinks to ensure correct threading.

3. Turn 2 CoolConnect® Inter-01 simultaneously to tighten heat sink connection.

CoolConnect® Inter-01



Two sides threading

CoolConnect® Inter-01 has threading on both sides and acts as a connection bridge that allows you to combine 2, 3 or more CoolBlock® LX-01-2x6 LED coolers

Model names

• CoolConnect® Inter-01