

AI Inference / DeviceEdge

Jetson System AIE-CN11/AIE- CN21/AIE-CT41



Features

- Support NVIDIA Jetson Module at Jetson Xavier™ NX and NVIDIA® Jetson™ TX2 NX.
- DC 12~19V power input.
- 1 x GbE LAN port and 1 x PoE/PD port
- Built-in M.2 M-key 2242 NVMe 128G SSD and support M.2 E-key 2230 for Wifi/BT Function
- Operating temperature range from -20°C~50°C
- Fanless and compact design

Specifications

Model Number	AIE-CN11	AIE-CN21	AIE-CT41
Module Compatibility	Nvidia Jetson Xavier NX 8G / 16G		Nvidia Jetson TX2 NX
Storage	16GB eMMC 5.1 Flash		
Display	1 x HDMI 2.0 With Micro HDMI D Type Connector		
Audio	HDMI Integrated		
LAN	2 x RJ-45 for GbE (1 For PoE PD 802.3 at)		
USB	2 x USB 3.2 Gen1 Type A 1 x USB Type-C (OTG Only)		
I/O Interfaces	5 x GPIO, 1 x UART, 1 x I ² C, 1 x CAN Bus		
Expansion	1 x M.2 M-key 2242 : NVMe 128G SSD (Build-in) 1 x M.2 E-key 2230 : Wifi/BT GPS Function		
MISC. Function	1 x AI Button (iTons) 1 x Power Button 1 x Recovery Button 1 x Reset Button 2 x Antenna (Optional)		
Power Input /Connector	DC-in 12V~19V / 4 Pin DC Jack		
Dimension(Wx Dx H)	132.6 x 88.7 x 63.6mm		
Mounting	VESA Mount / Din Rail		
Net Weight	970g		
Temperature	Operating Temperature: -20°C ~ +50°C Storage Temperature: -40°C ~ +85°C		
Humidity	5 to 90% @ 40°C Related Humidity, Non-condensing		
Certification	CE/FCC Class A		

System & Mounting Dimensions

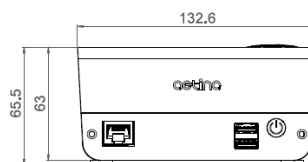
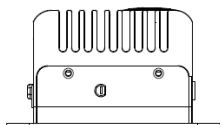
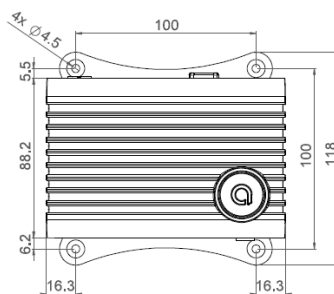
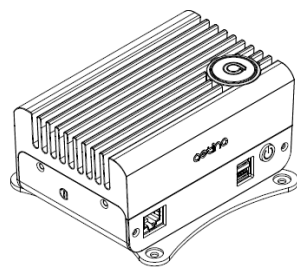

I/O Mechanical Layout

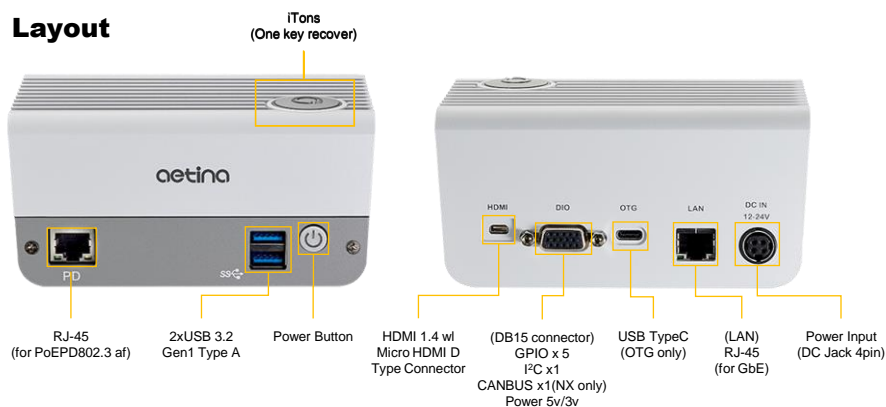

Ordering Information

Model name	Description
AIE-CN11-1-A1	AIE-CN11 Fanless system with Jetson Xavier NX 8G including DB15 Cable, 128G SSD, -20°C to +50°C
AIE-CN21-1-A1	AIE-CN21 Fanless system with Jetson Xavier NX 16G including DB15 Cable, 128G SSD, -20°C to +50°C
AIE-CT41-1-A1	AIE-CT41 Fanless system with Jetson TX2 NX including DB15 Cable, 128G SSD, -20°C to +50°C

Packing List

Part No.	Description	
43-060000-0000	MINI M1 SERIES : AIE-CN11/AIE-CN21/AIE-CT41Quick Start Guide	
43-0Z0000-0000	Safety Manual	
32-010000-0005 32-010000-0006	US POWER CORD EU POWER CORD	*Select one according to use of territory
53-0F0000-0003	Power Adapter 90~264V 60W 12V 5A BLACK - 30~70°C	
32-050000-000A	HDMI TYPE-D MALE TO TYPE-A FEMALE CABLE 100mm +/-8mm BLACK	
32-050000-0025	I/O CABLE (UART+I2C+GPIO+CANBUS)	
35-0A0000-0001	Mounting Bracket 118*118*2.5mm AL5052 Gray	

Accessory (Optional)

Part No.	Description
53-0G8265-0000	Intel AC8265.NGWMG WIFI/Bluetooth Module
55-AMINIS-Z000	Mini Series Din Rail Kit Assy

